

Crane Travelling Wheel

Overhead Crane Type Wheel

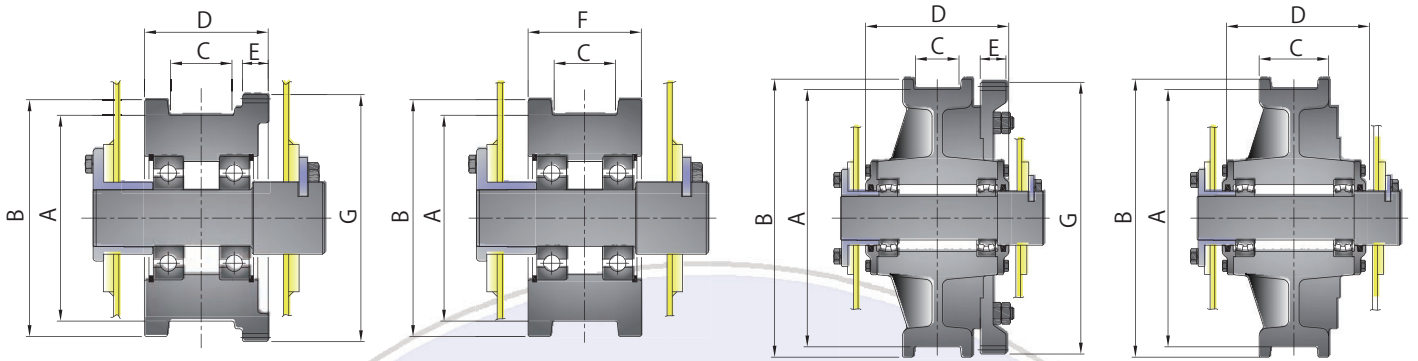

Driving Wheel

Following Wheel

Driving Wheel

Following Wheel

Ø160 ~ Ø250

Ø315 ~ Ø800

Wheel								Gear		Pinion		Application	Weight	
A(mm)	B(mm)	C(mm) (15/30 kg/m)	D(mm)	E(mm)	F(mm)	G(mm)	Bearing	Material	Module & Teeth	Material	Module & Teeth	Material	Motor(kWxP)	4ea (kg)
160	190	63/72	120	25	110	200	6310ZZ	S45C	M4x48T	S45C	M4x16T	S45CN (Hs 55~60)	0.5x6/0.75x4	160
200	230	63/72	120	25	110	6311ZZ	M4x58T		M4x16T		230			
250	280	63/72	120	25	110	295	6312ZZ		M5x57T		M5x15T		330	
315	355	63/72	176	30	127	360	#22213		M5x70T		M5x15T		440	
400	440	85	260	50	130	432	#22215	SCMn2A	M6x70T	SC49	M6x19T	1.5x6/2.2x4	750	
500	540	90	278	50	135	528	#22217		M6x86T		M6x19T		1140	
630	670	90	304	60	135	680	#22220		M8x83T		M8x16T	1490		
710	750	90	324	60	135	730	#22222		M10x71T		M10x12T	1810		
800	840	90	350	70	140	820	#22224	M10x80T	M10x12T	2560				

Suspension Crane Type Wheel

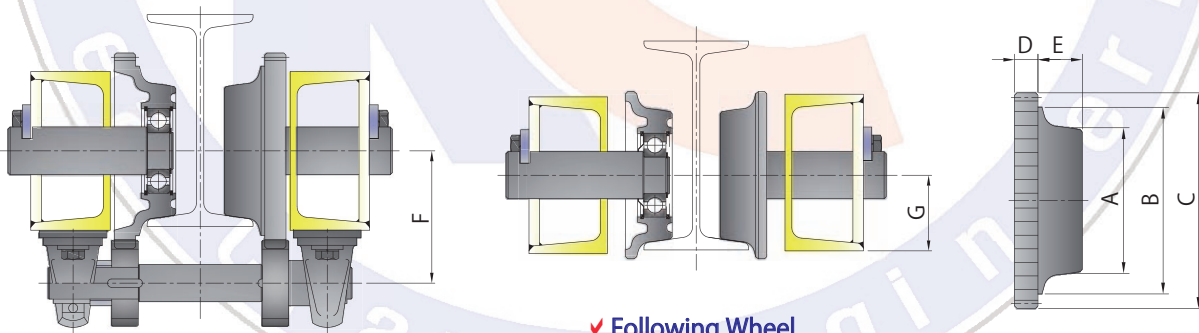

Driving Wheel

Following Wheel

Ø125 ~ Ø180

Wheel								Gear		Pinion		Application	Weight	
A(mm)	B(mm)	C(mm)	D(mm)	E(mm)	F(mm)	G(mm)	Bearing	Material	Module & Teeth	Material	Module & Teeth	Material	Motor(kWxP)	4ea (kg)
125	160	185	20	38	125	75	6207ZZ	S45CN	M4x43T	S45CN	M4x17T	S45CN (Hs 55~60)	0.5x6/0.75x4	95
160	200	239	20	54	150	6209ZZ	M4x56T		M4x17T		200			
180	220	248	25	64	161.5	100	6212ZZ		M5x49T		M5x14T		255	

- All materials applied are suitable in specified ambient temperature.
- KCE Inc reserves the right to alter or amend the above information without notice.
- The size can be changed according to detailed design.

✓ A-Type

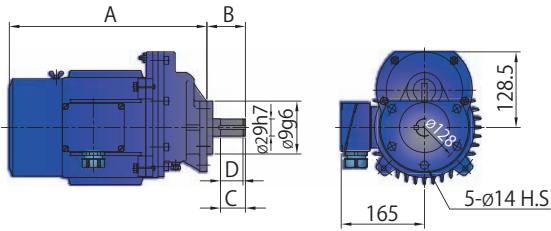

Dim. \ Cap.	0.5KW x 6P, 0.75KWx4P		1.0KW x 6P, 1.5KWx4P	
A	336		371	
B	56.5	77.5	87	
C	29	34	64	
D	25	30	60	
Reduce Ratio	1/8.4, 1/12.12, 1/16.3			

✓ B-Type

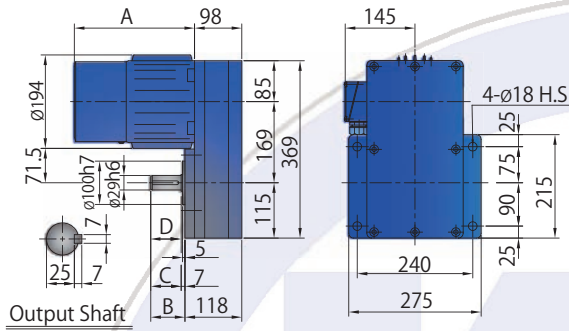

Dim. \ Cap.	0.5KW x 6P, 0.75KWx4P		1.0KW x 6P, 1.5KWx4P	
A	215		250	
B	71		71	
C	64		64	
D	60		60	
Reduce Ratio	1/12.4, 1/16.3, 1/22			

✓ C-Type

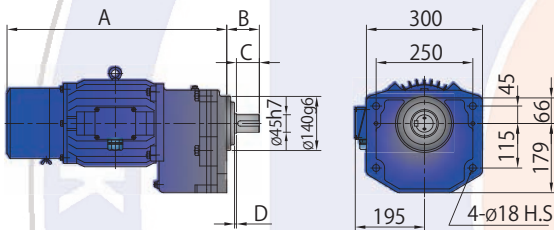

Dim. \ Cap.	1.5KW x 6P, 2.2KW x 4P	
A	565	
B	84	
C	59	
D	5	
Reduce Ratio	1/20.26	

✓ D-Type

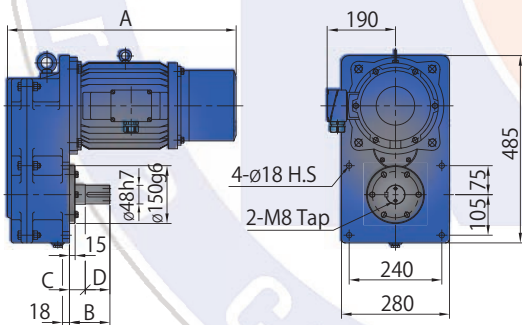

Dim. \ Cap.	2.2KW x 6P, 3.7KW x 4P, 5.5KWx4P	
A	592	
B	105	
C	41	
D	64	
Reduce Ratio	1/22	

✓ E-Type

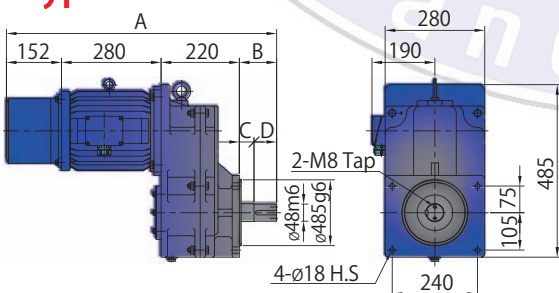

Dim. \ Cap.	2.2KW x 6P, 3.7KW x 4P, 5.5KWx4P	
A	757	
B	105	
C	41	
D	64	
Reduce Ratio	1/22	

- Feature 1) Geared motor with high standard gear guarantees quiet operation and comfortable work environment.
- 2) The user can choose the single speed or pole change speed according to purpose of usage.
- 3) All materials applied are suitable in specified ambient temperature.
- 4) KCE Inc reserves the right to alter or amend the above information without notice.

Push Button

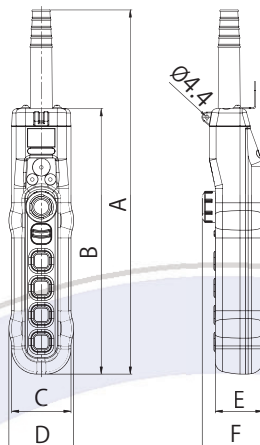

구분 (Division)	A	B	C	D	E	F
H04EAA (6 hole)	404.7	294.9	66.0	72.0	53.0	67.5
H06EAAA (8 hole)	464.7	354.9	66.0	72.0	53.0	67.5
정격 (Rating)		6A 250V AC				
접점 (Contact)		AgSnO2				
절연저항 (Insulation resistance)		100MΩ 이상 (min)				
내전압 (Dielectric strength)		1,500V AC 1분간 (min)				
재질 (Quality material)	바디 (Case)	고충격용 ABS (High impact ABS)				
	전선보호구 (Wire protection)	NBR (고무) NBR (speciality rubber)				
사용주의온도 (Temperature range)		-15℃ ~ +45℃				
사용주의습도 (Humidity range)		45 ~ 85% RH				
보호구조 (Protection structure)		IP-65				

✓ Push Button Switch (IP65)

Rectifier



BK-SR60

Model	Input voltage	Output voltage	Max. output current
SR 60	AC 220	DC 99V	DC 6A
BK-060J1	AC 380~480V	DC 90V	DC 12A



BK-060J1,G1

- Applicable device

- ✓ Used for traveling and hoisting brake systems such as cranes and hoist.
- ✓ Electro-magnetic motor brake controller.
- ✓ Various mechanical devices using electromagnets.
- ✓ LED lamp displays the operating status.

- Characteristic

- ✓ LED lamp displays the operating status.
- ✓ By adopting the PWM method by the microprocessor, the voltage is soft applied when the brake coil is operated in the form of strong excitation and weak excitation.
- ✓ Compact and lightweight, easy to install.
- ✓ Operating temperature range: -20℃ to +80℃

Hoisting Brake

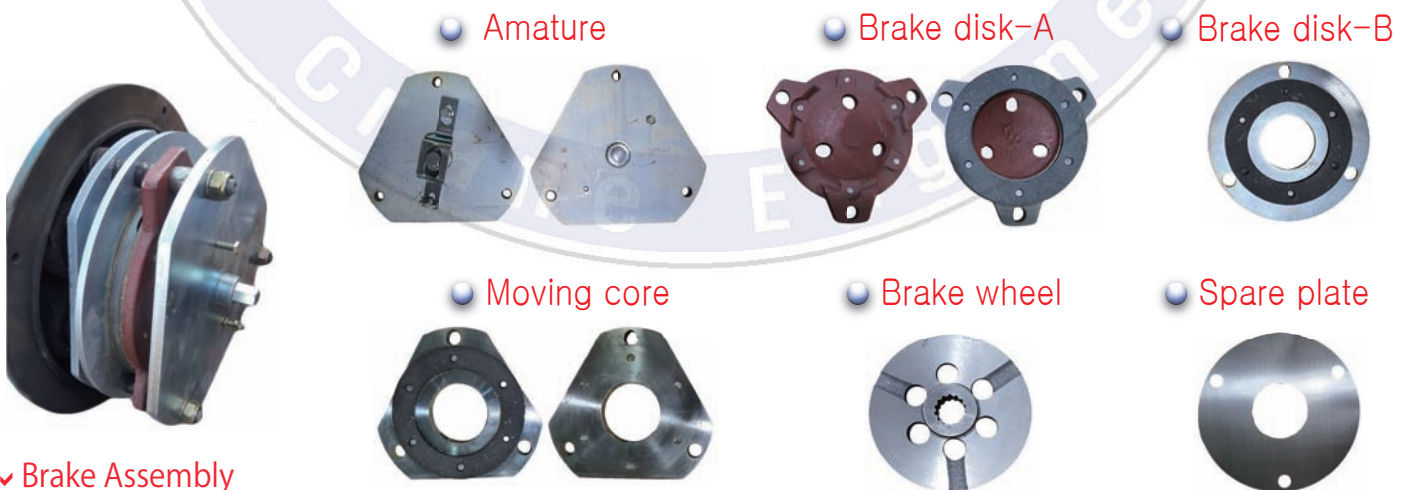

✓ Brake Assembly

- All materials applied are suitable in specified ambient temperature.
- KCE Inc reserves the right to alter or amend the above information without notice.
- The size can be changed according to detailed design.